

Screwless StSt holder system with loose conductor leading

Easy installation:

- Just push in the conductor

Advantages:

- Conductor is fixed in the DEHNgrip
- No more screwing



Height 20 mm

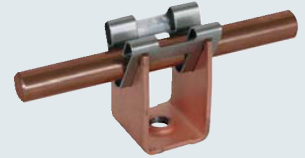
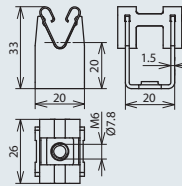

Part No.	207 019	207 009	207 017	207 007
Height of conductor holder	20 mm	20 mm	20 mm	20 mm
Thread of conductor holder	M6	—	M6	—
Bore of conductor holder	—	Ø 7.8 mm	—	Ø 7.8 mm
Material of conductor holder	StSt	StSt	Cu	Cu
Conductor holder support Rd	8 mm	8 mm	8 mm	8 mm
Standard	EN 50164-4	EN 50164-4	EN 50164-4	EN 50164-4

Height 32 mm

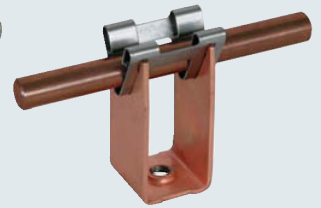
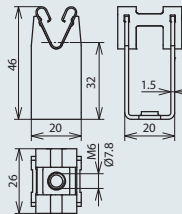

Part No.	207 039	207 029	207 037	207 027
Height of conductor holder	32 mm	32 mm	32 mm	32 mm
Thread of conductor holder	M6	—	M6	—
Bore of conductor holder	—	Ø 7.8 mm	—	Ø 7.8 mm
Material of conductor holder	StSt	StSt	Cu	Cu
Conductor holder support Rd	8 mm	8 mm	8 mm	8 mm
Standard	EN 50164-4	EN 50164-4	EN 50164-4	EN 50164-4

Height 20 mm premounted with screw, plastic base (grey) and dowel

Part No.	207 109
Height of conductor holder	20 mm
Bore of conductor holder	Ø 7.8 mm
Material of conductor holder	StSt
Conductor holder support Rd	8 mm
Screw	⊕ 5x50 mm
Plastic dowel	Ø 8x40 mm
Standard	EN 50164-4

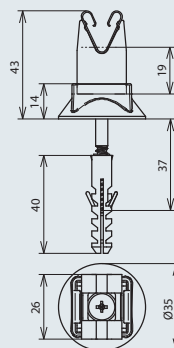



Plastic holder system with loose conductor leading

Easy mounting:

- Insert the conductor laterally
- Press fit the cap (self-locking)

Advantages:

- Conductor is held in a massive recess in the base body, thus no strain on the latch
- Double cap catch (open with tool)
- Straight and loose conductor leading
- Robust and weather-resistant design
- UV stabilised, halogen-free

Height 16 mm with female thread

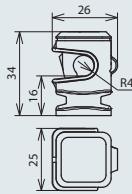
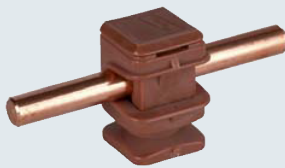

Part No.	204 001	204 007	204 002	204 017
Height of conductor holder	16 mm	16 mm	16 mm	16 mm
Thread of conductor holder	M6	M6	M8	M8
Material of conductor holder	plastic	plastic	plastic	plastic
Colour of conductor holder	grey	brown	grey	brown
Conductor holder support Rd	8 mm	8 mm	8 mm	8 mm

Height 36 mm with female thread

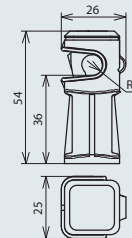

Part No.	204 003	204 027	204 004	204 037
Height of conductor holder	36 mm	36 mm	36 mm	36 mm
Thread of conductor holder	M6	M6	M8	M8
Material of conductor holder	plastic	plastic	plastic	plastic
Colour of conductor holder	grey	brown	grey	brown
Conductor holder support Rd	8 mm	8 mm	8 mm	8 mm

Height 16 mm with screw

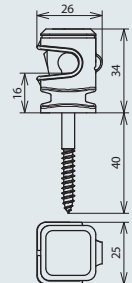

Part No.	204 006
Height of conductor holder	16 mm
Thread of conductor holder	M8
Material of conductor holder	plastic
Colour of conductor holder	grey
Conductor holder support Rd	8 mm
Screw	⌈ 5x50 mm

Height 16 mm premounted with screw, cover plate and dowel

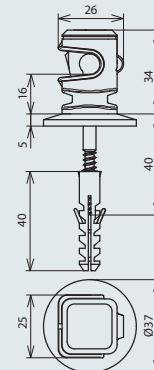

Part No.	204 120
Height of conductor holder	16 mm
Thread of conductor holder	M8
Material of conductor holder	plastic
Colour of conductor holder	grey
Conductor holder support Rd	8 mm
Screw	⌈ 5x50 mm
Plastic dowel	∅8x40 mm

Conductor holder with slotted cleat for fixing of round conductors, fixed conductor leading

For use with different materials e.g. Al, StSt, St/tZn and Cu



With female thread

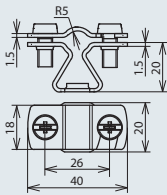

Part No.	274 110	274 117
Material of conductor holder	StSt	StSt / gal Cu
Conductor holder support Rd	8-10 mm	8-10 mm
Conductor holder support Fl	20 mm	20 mm
Height of conductor holder	20 mm	20 mm
Thread of conductor holder	M8	M8
Standard	EN 50164-4	—

With female thread, e.g. for round wire with plastic coating

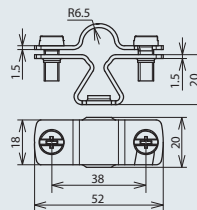

Part No.	274 113
Material of conductor holder	StSt
Conductor holder support Rd	13 mm
Height of conductor holder	20 mm
Thread of conductor holder	M8

With female thread, premounted with plastic base

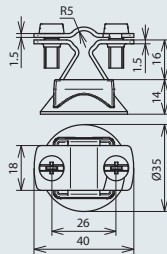

Part No.	274 150
Material of conductor holder	StSt
Conductor holder support Rd	8-10 mm
Conductor holder support Fl	20 mm
Height of conductor holder	20 mm
Thread of conductor holder	M8

With female thread, premounted with screw, plastic base and dowel

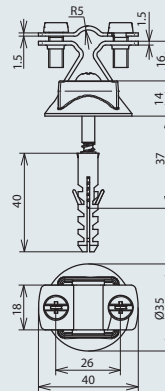

Part No.	274 160	274 167
Material of conductor holder	StSt	StSt / gal Cu
Conductor holder support Rd	8-10 mm	8-10 mm
Conductor holder support Fl	20 mm	20 mm
Height of conductor holder	20 mm	20 mm
Thread of conductor holder	M8	M8
Plastic base	grey	brown
Screw	⚙ 5x50 mm	⚙ 5x50 mm
Plastic dowel	∅8x40 mm	∅8x40 mm
Standard	EN 50164-4	—

Cover disc and plastic base as an intermediate element for screwable / snap-on conductor holders and rod holders

Cover discs, plastic

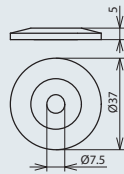
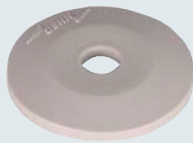

Part No.	276 006	276 007
Height	5 mm	5 mm
Diameter	37 mm	37 mm
Material	plastic	plastic
Colour	grey	brown
Type	UV stabilized	UV stabilized

Cover disc, StSt

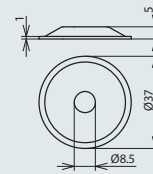

Part No.	276 009
Height	5 mm
Diameter	37 mm
Material	StSt

Plastic bases

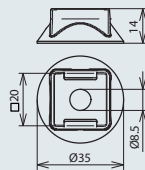

For snapping onto the conductor holders DEHNgrip and DEHNhold

Part No.	276 016	276 017
Height	10 mm	10 mm
Diameter	35 mm	35 mm
Material	plastic	plastic
Colour	grey	brown
Type	UV stabilized	UV stabilized

Conductor Holder with Cleat – Flat Design

Two-screws-cleat with screws M6, for round and flat conductors

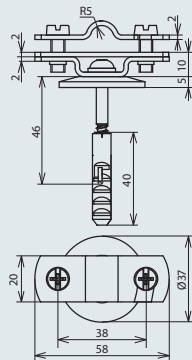

Part No.	286 819
Conductor holder support Rd	7-10 mm
Conductor holder support Fl	30 mm
Height of conductor holder	10 mm
Material of conductor holder	StSt
Screw	⌘ 5x50 mm
Plastic dowel	∅8x50 mm
Standard	EN 50164-4

Complete unit with flange for the installation of conductors, fixed conductor leading

With female thread M8

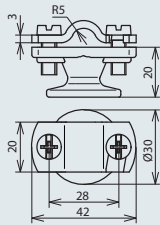

Part No.	275 110
Conductor holder support Rd	7-10 mm
Thread of conductor holder	M8
Height of conductor holder	20 mm
Material of cleat	St/tZn
Material of base part	ZDC
Standard	EN 50164-4

With female thread, e.g. for round wire with plastic coating

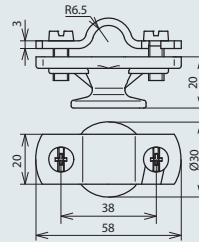

Part No.	275 113
Conductor holder support Rd	13 mm
Thread of conductor holder	M8
Height of conductor holder	20 mm
Material of cleat	St/tZn
Material of base part	ZDC

With female thread, premounted with screw and dowel

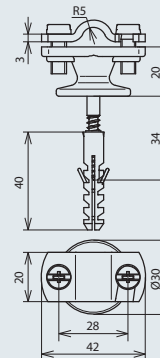

Part No.	275 160
Conductor holder support Rd	7-10 mm
Thread of conductor holder	M8
Height of conductor holder	20 mm
Material of cleat	St/tZn
Material of base part	ZDC
Screw	⌀5x50 mm
Plastic dowel	Ø8x40 mm
Standard	EN 50164-4

DEHNfix® Conductor Holders

Two-in-one system (fixing of holder and conductor) with conductor holder DEHNQUICK, fixed conductor leading, UV stabilised, height (h1) 30 mm, bore depth (h2) 45 mm, bore Ø8 mm

Easy mounting:

- Just prebore
- Put in holder with inserted conductor
- Fix with a few hammer blows

Advantages:

- Cleat, spacer and dowel form a single unit
- Premounted, ready for driving in

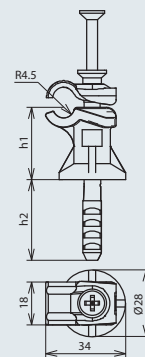

Part No.	250 000	250 001	250 007
Material of cleat	St/tZn	StSt	Cu
Material of base part	plastic	plastic	plastic
Height of base part	30 mm	30 mm	30 mm
Conductor holder support Rd	6-10 mm	6-10 mm	6-10 mm
Colour of conductor holder	grey	grey	brown
Striking dowel	75/30 mm	75/30 mm	75/30 mm

Note: Only suitable for massive stones or concrete

Two-screws-cleat with screws M6, for round and flat conductors

With square pin

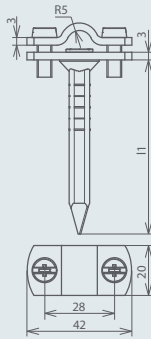

Part No.	260 708	260 108	260 158	260 187
Conductor holder support Rd	7-10 mm	7-10 mm	7-10 mm	7-10 mm
Conductor holder support Fl	20 mm	20 mm	20 mm	20 mm
Material of cleat	St/tZn	St/tZn	St/tZn	Cu
Material of base part	St/tZn	St/tZn	St/tZn	Cu
Fixing (l1)	square pin 70 mm	square pin 100 mm	square pin 150 mm	square pin 100 mm

With loose round pin

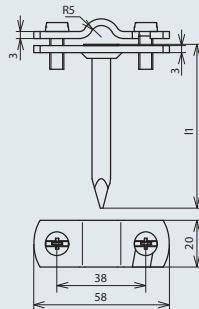

Part No.	262 070	262 100
Conductor holder support Rd	7-10 mm	7-10 mm
Conductor holder support Fl	30 mm	30 mm
Material of cleat	St/tZn	St/tZn
Material of base part	St/tZn	St/tZn
Fixing (l1)	round pin 70 mm	round pin 100 mm

Conductor Holders for External Thermal Insulation Composite Systems

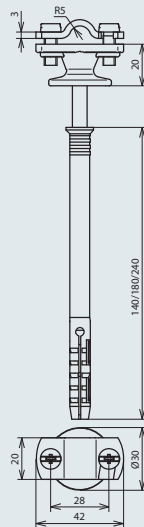

Conductor holders for fixing down conductors at walls with external thermal insulation composite system

Two-screws-cleat with screws M6, fixed conductor leading

Part No.	273 740	273 741	273 742
Thickness of insulating material	approx. 60 mm	approx. 110 mm	approx. 130 mm
Bore depth	approx. 150 mm	approx. 190 mm	approx. 250 mm
Conductor holder support Rd	7-10 mm	7-10 mm	7-10 mm
Material of base part	ZDC	ZDC	ZDC
Material of cleat	St/tZn	St/tZn	St/tZn
Height of conductor holder	20 mm	20 mm	20 mm
Screw of dowel	TX40 7x140 mm	TX40 7x180 mm	TX40 7x240 mm
Standard	EN 50164-4	EN 50164-4	EN 50164-4

Conductor holder for wall mounting with clamping screw M6, fixed conductor leading

Part No.	273 019
Bore Ø	6.5 mm
Material of conductor holder	StSt
Conductor holder support Rd	6-10 mm
Height of conductor holder	22 mm
Screw	 M6x20 mm
Material of screw	StSt

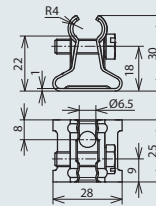

Conductor Holder Cleats

Conductor holders for the installation of round conductors e.g. flush-mounted or wall-mounted (under the thermal insulation composite system)

DEHNQUICK

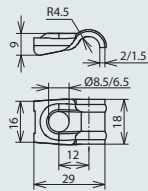

Single-screw-cleat with flexible clamping range and fixed conductor leading

Part No.	202 000	202 001	202 169
Material of conductor holder	St/tZn	StSt	StSt
Conductor holder support Rd	6-10 mm	6-10 mm	6-10 mm
Bore Ø	8.5 mm	8.5 mm	6.5 mm

Clamping frame

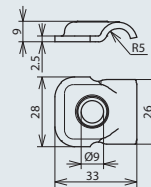

Single-screw-cleat for clamping frames with flexible clamping range and fixed conductor leading

Part No.	390 110	390 119
Material of conductor holder	St/tZn	StSt
Conductor holder support Rd	6-10 mm	6-10 mm
Bore Ø	9 mm	9 mm

Conductor Holder for Flush Mounting

Conductor holder with clamping plate for nailing

Part No.	260 118
Conductor holder support Rd	6-10 mm
Material of conductor holder	St/tZn
Conductor leading	fixed/loose
Fixing	square pin 70 mm
Clamping plate	36x20x3 mm

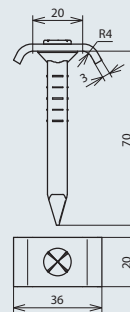

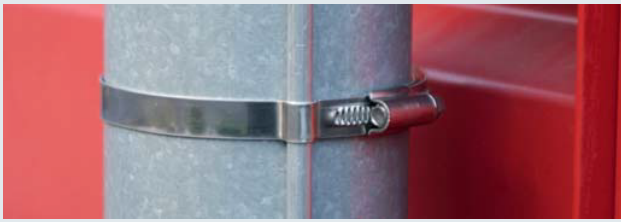

Conductor holders for the installation of down conductors at downpipes with fixed conductor leading
 All types are suitable also for plastic downpipes.

Type PPS

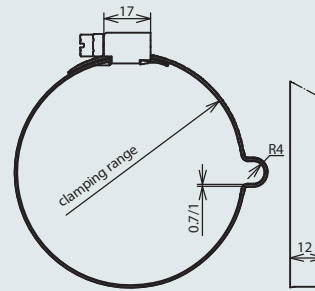

With worm drive and bead

Part No.	200 079	200 077	200 089	200 087
Clamping range Ø pipe	80-100 mm	80-100 mm	100-120 mm	100-120 mm
Conductor holder support Rd	8 mm	8 mm	8 mm	8 mm
Material of conductor holder	StSt	StSt / gal Cu	StSt	StSt / gal Cu
Screw	screw with worm drive SW7 mm	screw with worm drive SW7 mm	screw with worm drive SW7 mm	screw with worm drive SW7 mm
Material of grip head/screw	StSt	StSt / gal Cu	StSt	StSt / gal Cu

Type PS

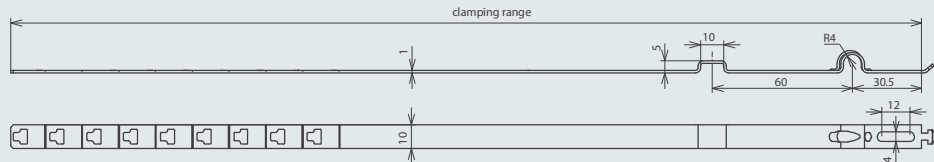
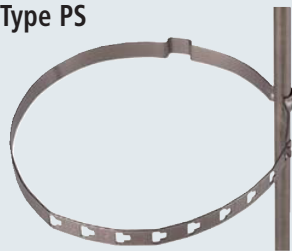

Screwless, with embossments for tongs

Part No.	200 069	200 067	200 059	200 057
Clamping range Ø pipe	80-120 mm, in steps of 5 mm	80-120 mm, in steps of 5 mm	100 mm	100 mm
Conductor holder support Rd	8 mm	8 mm	8 mm	8 mm
Material of conductor holder	StSt	Cu	StSt	Cu

Type PV



Adjustable, with clamping screw M8

Part No.	200 029	200 039	200 027
Clamping range Ø pipe	50-120 mm	50-150 mm	50-120 mm
Conductor holder support Rd	6-8 mm	6-8 mm	6-8 mm
Material of conductor holder	StSt	StSt	Cu/bronze
Screw	⚙ (SW13) M8x16 mm	⚙ (SW13) M8x16 mm	⚙ (SW13) M8x16 mm
Material of grip head/screw	StSt	StSt	StSt

Plastic conductor holders for insulated fixing of earth entries at metal downpipes
 Allows for measuring without detaching
 Holder with clamping part for tensioning strap fixing (dimension 14x0.3 mm)

For round conductors

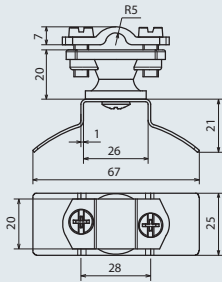

For round conductors, fixed conductor leading, made of weather-resistant plastic, UV stabilised and halogen-free.

Part No.	275 711
Material of conductor holder	PA
Material of clamping part	StSt
Conductor holder support Rd	6-11 mm

For flat strips or round conductors

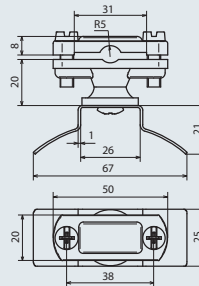

For round conductors and flat strips, fixed conductor leading, made of weather-resistant plastic, UV stabilised and halogen-free.

Part No.	275 730
Material of conductor holder	PA
Material of clamping part	StSt
Conductor holder support Rd	6-11 mm
Conductor holder support Fl	30 mm

For earth entry rods

For earth entry rods, fixed conductor leading, made of weather-resistant plastic, UV stabilised and halogen-free

Part No.	275 716
Material of conductor holder	PA
Material of clamping part	StSt
Conductor holder support Rd	16 mm

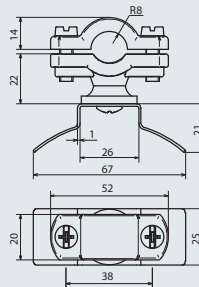

Single Part for Conductor Holders / Accessory for Plastic Conductor Holders for Downpipes

Separate grip head

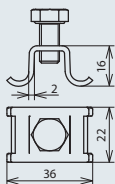

For combination with endless tensioning strap (Part No. 540 931)

Part No.	540 930
Conductor holder support Rd	6-8 mm
Material of conductor holder	StSt
Screw	SW13) M8x16 mm
Material of grip head/screw	StSt

Endless tensioning strap



For cutting to length with sheet shears

Part No.	540 931
Material of conductor holder	StSt
Dimension of strap (w x d)	14x0.3 mm
Length	50 m

Staples for fixing conductors e.g. at wooden masts etc.

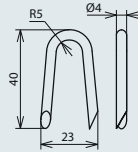

Part No.	538 010
Material of conductor holder	St/tZn
Conductor holder support Rd	6-10 mm
Conductor leading	fixed/loose

Rod Holders DEHNhold

Rod holders for fixing of air-termination rods and earth entry rods, with slotted cleat, fixed conductor leading
For use with different materials e.g. Al, StSt, St/tZn and Cu

With female thread

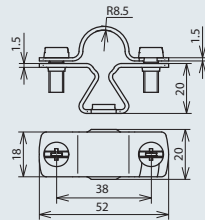

Part No.	274 116
Material of conductor holder	StSt
Conductor holder support Rd	16 mm
Height of conductor holder	20 mm
Thread of conductor holder	M8

Premounted with screw, plastic base and dowel

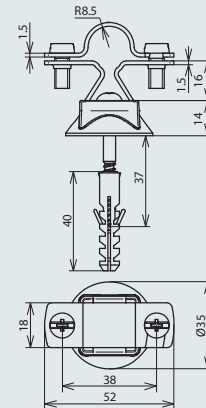

With female thread

Part No.	274 260
Material of conductor holder	StSt
Conductor holder support Rd	16 mm
Height of conductor holder	20 mm
Thread of conductor holder	M8
Screw	⌀ 5x50 mm
Plastic dowel	⌀8x40 mm

Complete unit with flange for the installation of air-termination rods and earth entry rods, fixed conductor leading

With female thread

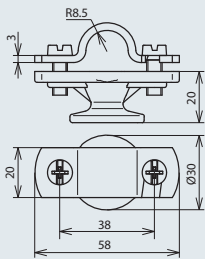

Part No.	275 116
Conductor holder support Rd	16 mm
Thread of conductor holder	M8
Height of conductor holder	20 mm
Material of cleat	St/tZn
Material of base part	ZDC

Premounted with screw and dowel

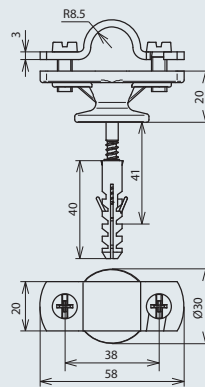

Part No.	275 260
Conductor holder support Rd	16 mm
Thread of conductor holder	M8
Height of conductor holder	20 mm
Material of cleat	St/tZn
Material of base part	ZDC
Screw	⚙ 5x50 mm
Plastic dowel	Ø8x40 mm

Rod Holders with Cleat and Pin

With square pin

Two-screws-cleat with screws M6 for air-termination and earth entry rods, fixed conductor leading

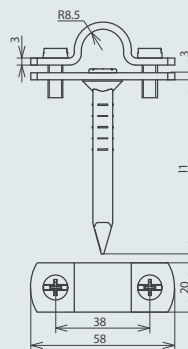

Part No.	260 106
Material of cleat	St/tZn
Material of base part	St/tZn
Conductor holder support Rd	16 mm
Fixing (I1)	square pin 100 mm

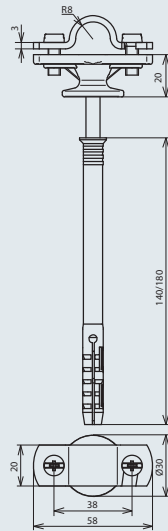

Two-screws-cleat with screws M6, with flange (ZDC) and plastic dowel Ø10 mm

Part No.	273 731
Thickness of insulating material	approx. 110 mm
Depth of bore	approx. 190 mm
Material of cleat	St/tZn
Material of base part	ZDC
Height of conductor holder	20 mm
Conductor holder support Rd	16 mm
Screw/dowel	TX40 7x180 mm

Rod Holders DEHNfix®

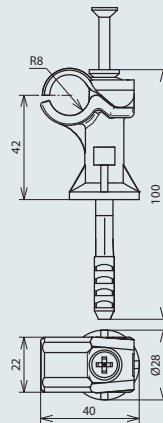

Holder system with two functions (fixing of holder and conductor), fixed conductor leading
Only suitable for massive stones or concrete

Part No.	252 000
Material of cleat	St/tZn
Material of base part	plastic
Colour of conductor holder	grey
Installation height of base part	42 mm
Conductor holder support Rd	16 mm
Impact dowel	100/60 mm
Bore Ø for impact dowel	10 mm
Bore depth	60 mm

Rod Holder with Claw

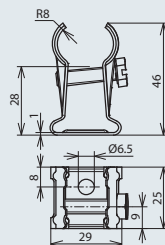

Rod holder for wall mounting with fixing screw M6, fixed conductor leading

Part No.	275 019
Bore Ø	6.5 mm
Material of conductor holder	StSt
Height of conductor holder	28 mm
Conductor holder support Rd	13-16 mm
Screw	M6x25 mm
Material of screw	StSt

Flat strip holders for the fixing of flat conductors with slotted cleat, fixed conductor leading

For use with different materials e.g. Al, StSt, St/tZn and Cu



Premounted with screw, plastic base and dowel

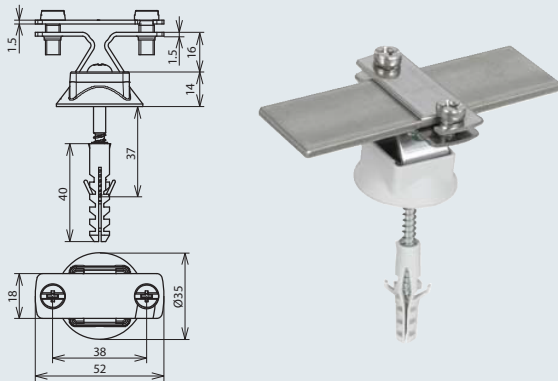

Part No.	274 230
Material of conductor holder	StSt
Conductor holder support Fl	30x3.5 mm
Conductor holder support Rd	6-10 mm
Height of conductor holder	20 mm
Thread of conductor holder	M8
Screw	⚙️ 5x50 mm
Plastic dowel	Ø8x40 mm
Standard	EN 50164-4

With female thread

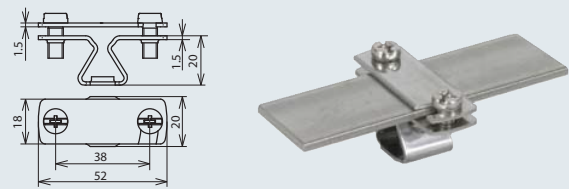

Part No.	274 030
Material of conductor holder	StSt
Conductor holder support Fl	30x3.5 mm
Conductor holder support Rd	6-10 mm
Height of conductor holder	20 mm
Thread of conductor holder	M8
Standard	EN 50164-4

Two-screws-cleat with screws M6

With slot (6.5x16 mm)

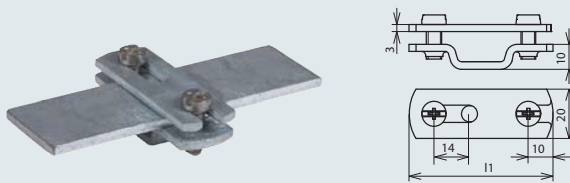

Part No.	284 030	284 040
Height of conductor holder	10 mm	10 mm
Conductor holder support Fl	30x3.5 mm	40x4-5 mm
Material of conductor holder	St/tZn	St/tZn
Material of base part	St/tZn	St/tZn
Dimension (l1)	58 mm	70 mm
Standard	EN 50164-4	EN 50164-4

With slot (6.5x16 mm) and premounted wood screw

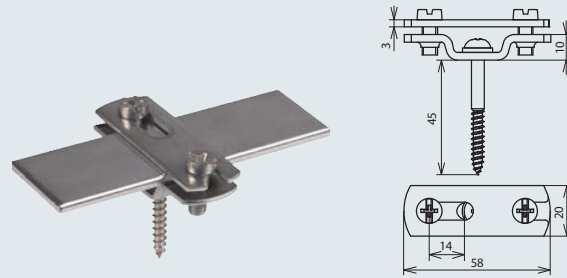

Part No.	286 030	286 139
Height of conductor holder	10 mm	10 mm
Conductor holder support Fl	30x3.5 mm	30x3.5 mm
Material of conductor holder	St/tZn	StSt
Material of base part	St/tZn	StSt
Screw	⌘ 5x50 mm	⌘ 5x50 mm
Dimension (l1)	58 mm	58 mm
Standard	EN 50164-4	EN 50164-4

Flat Strip Holders with Cleat and Flange

Complete unit with flange for the installation of strip conductors

With female thread

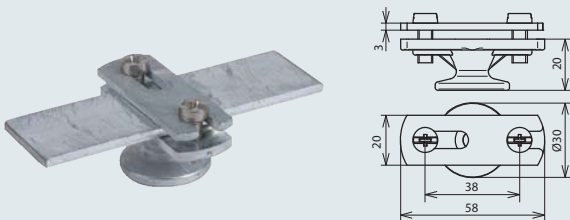

Part No.	275 030
Conductor holder support Fl	30x30.5 mm
Thread of conductor holder	M8
Height of conductor holder	20 mm
Material of cleat	St/tZn
Material of base part	ZDC
Standard	EN 50164-4

With female thread, premounted with screw and dowel

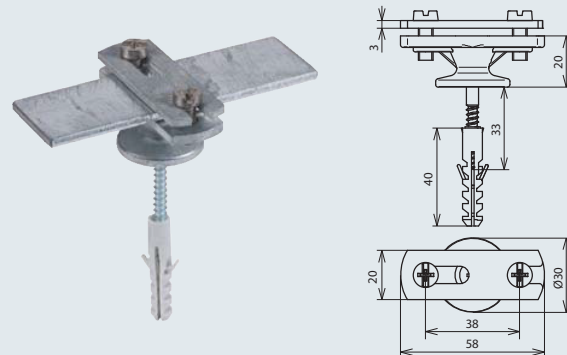

Part No.	275 230
Conductor holder support Fl	30x3.5 mm
Thread of conductor holder	M8
Height of conductor holder	20 mm
Material of cleat	St/tZn
Material of base part	ZDC
Screw	⌘ 5x50 mm
Plastic dowel	∅8x40 mm
Standard	EN 50164-4

Flat strip holders for wall mounting

Thrust piece with screw M8 for the installation of strip conductor up to 11 mm and round conductor 6-10 mm



Wall distance 11 mm

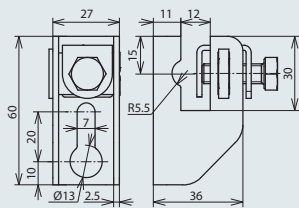

Part No.	277 230	277 237	277 239
Material of conductor holder	St/tZn	Cu	StSt
Wall distance	11 mm	11 mm	11 mm
Fixing	Ø13 und 7x20 mm	Ø13 und 7x20 mm	Ø13 und 7x20 mm
Slot width	12 mm	12 mm	12 mm
Screw	⚙ M8x25 mm	⚙ M8x25 mm	⚙ M8x25 mm
Material of screw	StSt	StSt	StSt
Standard	EN 50164-4	EN 50164-4	EN 50164-4

Wall distance 15 mm

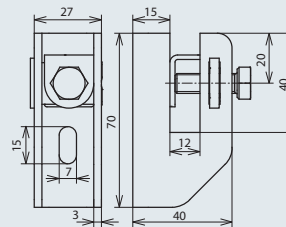

Part No.	277 240
Material of conductor holder	St/tZn
Wall distance	15 mm
Fixing	7x15 mm
Slot width	12 mm
Screw	⚙ M8x25 mm
Material of screw	StSt
Standard	EN 50164-4

Staples for Flat Strips

Staples for fixing strip conductors e.g. at wooden masts etc.

Part No.	538 030
Material of conductor holder	St/tZn
Conductor holder support Fl	30 mm
Conductor leading	fixed/loose

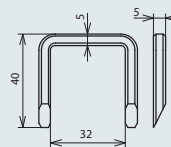

Dowels for rigid foam plates to fix conductor holders, flat strip and rod holders in external thermal insulation composite systems.

With star drive (TX40)

Mounting with wood screws $\varnothing 4.5$ mm

These dowel are only suitable for conductor holder fixing, if there are no additional tensile forces on the down conductor.

Short design

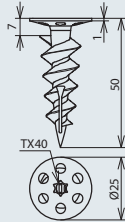

Part No.	200 600
Material	PA
Thickness of insulating material	60 mm
Length of anchoring depth	50 mm
Working load of Styrofoam PS20	35 N
Working load of rigid foam plates	60 N

Long design

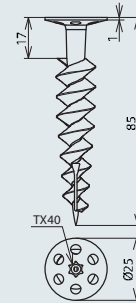

Part No.	200 601
Material	PA
Thickness of insulating material	100 mm
Length of anchoring depth	85 mm
Working load of Styrofoam PS20	60 N
Working load of rigid foam plates	85 N

More details in installation instructions No. 1459.

Wood Screws with Threaded Head

Hanger bolt for fixing of conductor, flat strip and rod holders with female thread

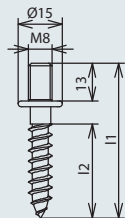

Part No.	528 850	528 870
Material	St/gal Zn	St/gal Zn
Thread	M8	M8
Length (l1)	53 mm	73 mm
Length (l2)	32 mm	42 mm