

Disconnecting sleeves for connecting down conductors to the earth entries

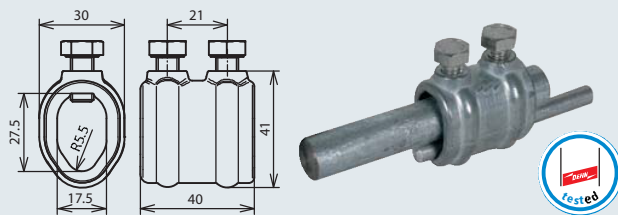

Open design for earth entry rods



Part No.	450 000	450 007
Material	ZDC	RCB
Clamping range Rd / Rd	7-10 / 16 mm	7-10 / 16 mm
Screw	⚙ M8x16 mm	⚙ M8x16 mm
Material of screw	StSt	StSt
Standard	EN 50164-1	EN 50164-1

Open design for earth entry rods

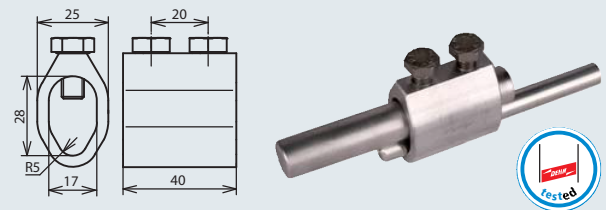

Part No.	450 001
Material	Al
Clamping range Rd / Rd	8-10 / 16 mm
Screw	⚙ M8x16 mm
Material of screw	StSt
Standard	EN 50164-1

Closed design for earth entry rods

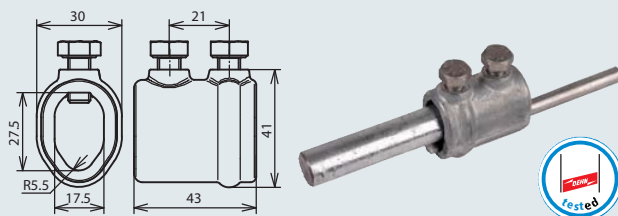

Part No.	450 011
Material	ZDC
Clamping range Rd / Rd	7-10 / 16 mm
Screw	⚙ M8x16 mm
Material of screw	StSt
Standard	EN 50164-1

Open design for wires

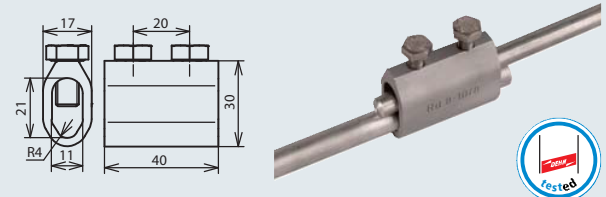

Part No.	450 101
Material	Al
Clamping range Rd / Rd	8-10 / 8 mm
Screw	⚙ M8x16 mm
Material of screw	StSt
Standard	EN 50164-1

Disconnecting clamps for connecting down conductors to the earth entries

With intermediate plate for two round conductors

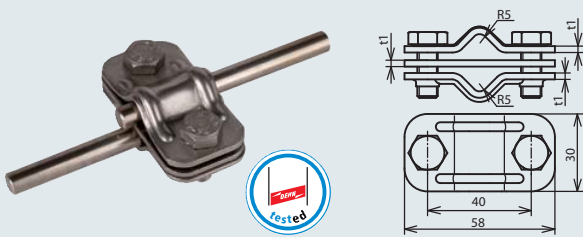

Part No.	459 129	459 127
Material	StSt	Cu
Clamping range Rd / Rd	8-10 / 8-10 mm	8-10 / 8-10 mm
Screw	M8x20 mm	M8x20 mm
Material of screw	StSt	StSt
Distance of screws	40 mm	40 mm
Material thickness (t1)	2.5 mm	3 mm
Standard	EN 50164-1	EN 50164-1

Bimetallic, for two round conductores St/tZn or StSt (V4A)

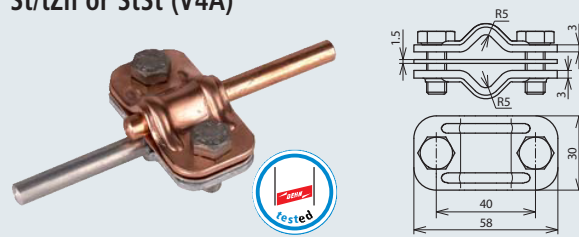

Part No.	460 517
Material	Cu / St/tZn
Clamping range Rd / Rd	8-10 / 8-10 mm
Screw	M8x20 mm
Material of screw	StSt
Distance of screws	40 mm
Material thickness (t1)	3 / 1.5 mm
Standard	EN 50164-1

With intermediate plate for round and flat conductor

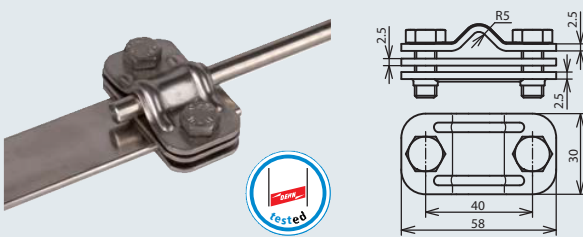

Part No.	459 139
Material	StSt
Clamping range Rd / Fl	8-10 / 30 mm
Screw	M8x20 mm
Material of screw	StSt
Distance of screws	40 mm
Material thickness (t1)	2.5 mm
Standard	EN 50164-1

Bimetallic, for round conductor Cu and flat conductor St/tZn or StSt (V4A)

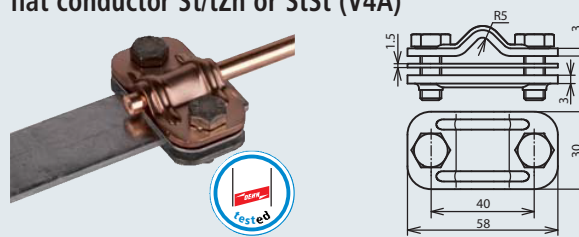

Part No.	460 557
Material	Cu / St/tZn
Clamping range Rd / Fl	8-10 / 30 mm
Screw	M8x20 mm
Material of screw	StSt
Distance of screws	40 mm
Material thickness (t1)	3 / 1.5 mm
Standard	EN 50164-1

With intermediate plate for earth entry rods

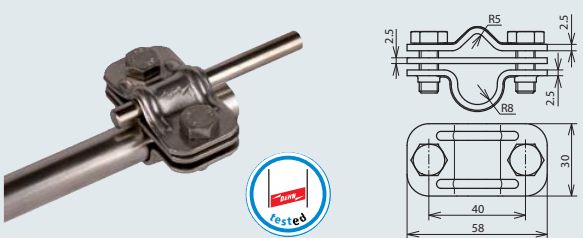

Part No.	459 119
Material	StSt
Clamping range Rd / Rd	8-10 / 16 mm
Screw	M8x20 mm
Material of screw	StSt
Distance of screws	40 mm
Material thickness (t1)	2.5 mm
Standard	EN 50164-1

Bimetallic, for round conductor Cu and earth entry rod St/tZn or StSt (V4A)



Part No.	460 507
Material	Cu / St/tZn
Clamping range Rd / Rd	8-10 / 16 mm
Screw	M8x20 mm
Material of screw	StSt
Distance of screws	40 mm
Material thickness (t1)	3 / 1.5 mm
Standard	EN 50164-1

With intermediate plate for two round conductors, small design

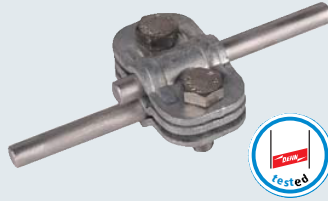
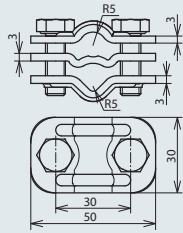

<b>Part No.</b>	<b>459 003</b>
Material	St/tZn
Clamping range Rd / Rd	7-10 / 7-10 mm
Screw	M8x25 mm
Material of screw	StSt
Distance of screws	30 mm
Material thickness (t1)	3 mm
Standard	EN 50164-1

With intermediate plate for earth entry rods, small design

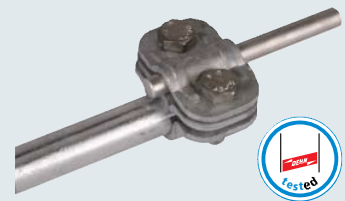
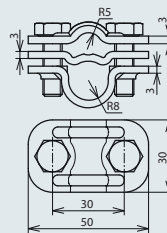

<b>Part No.</b>	<b>459 000</b>
Material	St/tZn
Clamping range Rd / Rd	7-10 / 16 mm
Screw	M8x25 mm
Material of screw	StSt
Distance of screws	30 mm
Material thickness (t1)	3 mm
Standard	EN 50164-1

Without intermediate plate for two round conductors

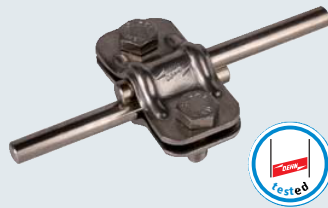
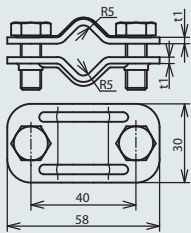

<b>Part No.</b>	<b>459 029</b>	<b>459 020</b>
Material	StSt	St/tZn
Clamping range Rd / Rd	8-10 / 8-10 mm	8-10 / 8-10 mm
Screw	M8x20 mm	M8x20 mm
Material of screw	StSt	StSt
Distance of screws	40 mm	40 mm
Material thickness (t1)	2.5 mm	3 mm
Standard	EN 50164-1	EN 50164-1

Without intermediate plate for round and flat conductor

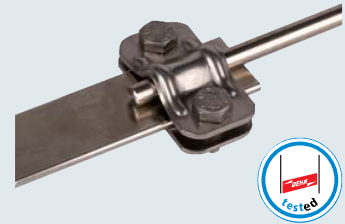
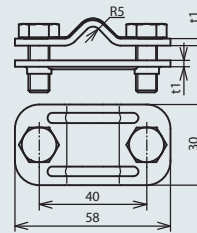

<b>Part No.</b>	<b>459 039</b>	<b>459 030</b>
Material	StSt	St/tZn
Clamping range Rd / Fl	8-10 / 30 mm	8-10 / 30 mm
Screw	M8x20 mm	M8x20 mm
Material of screw	StSt	StSt
Distance of screws	40 mm	40 mm
Material thickness (t1)	2.5 mm	3 mm
Standard	EN 50164-1	EN 50164-1

Without intermediate plate for earth entry rods

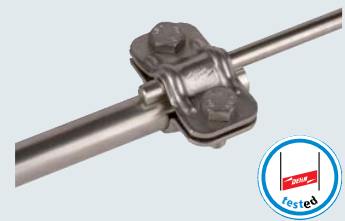
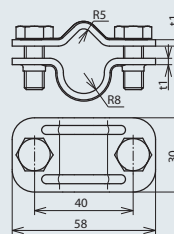

<b>Part No.</b>	<b>459 019</b>	<b>459 010</b>
Material	StSt	St/tZn
Clamping range Rd / Rd	8-10 / 16 mm	8-10 / 16 mm
Screw	M8x20 mm	M8x20 mm
Material of screw	StSt	StSt
Distance of screws	40 mm	40 mm
Material thickness (t1)	2.5 mm	3 mm
Standard	EN 50164-1	EN 50164-1

Single-screw disconnecting clamp to connect down conductors to earth entries

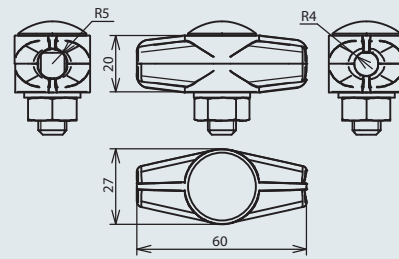

<b>Part No.</b>	<b>463 010</b>
Material	ZDC
Clamping range Rd / Rd	8 / 10 mm
Screw	⬆ M10x30 mm
Material of screw/nut	StSt
Standard	EN 50164-1

## Disconnecting Clamp – Austrian Standard

Disconnecting clamp with connecting screw, for round conductors

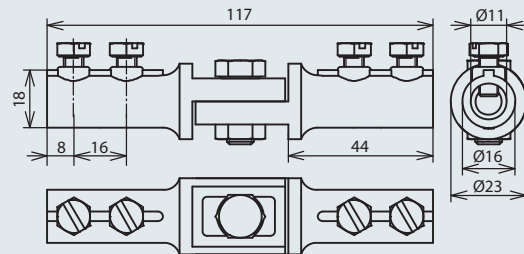

<b>Part No.</b>	<b>460 213</b>
Material	ZDC
Clamping range Rd / Rd	7-10 / 7-10 mm
Screw	⬆ M6x12 / ⬆ M8x25 mm
Material of screw/nut	StSt
Standard	EN 50164-1

## FIX Test Joint

Test joint with insulating piece and disconnection lug

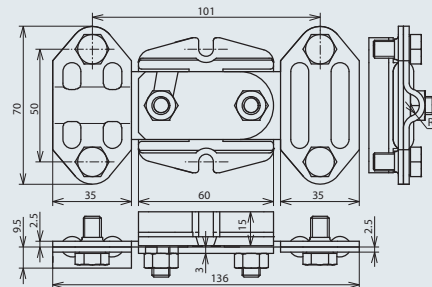

<b>Part No.</b>	<b>453 100</b>
Material	St/tZn
Clamping range Rd / Fl	8-10 / 30-40 mm
Screw	⬆ M8x16/M8x20 mm
Material of screw/nut	StSt
Insulating piece	plastic grey
Standard	EN 50164-1

Type for conductors Rd 8-10 and Rd 10-10 upon request

Two-part or three-part connection system with thread in the base part

Two-part, for round and flat conductors

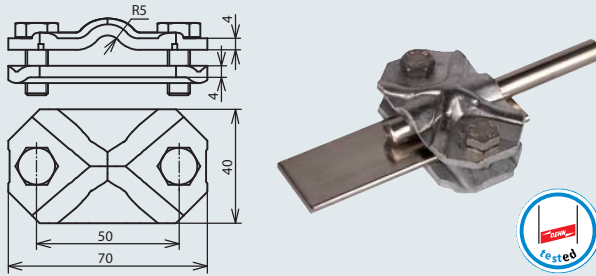

Part No.	454 100	454 107
Material	St/tZn	Cu
Clamping range Rd / Fl	7-10 / 30-40 mm	7-10 / 30-40 mm
Screw	☛ M8x20 mm	☛ M8x20 mm
Material of screw	StSt	StSt
Standard	EN 50164-1	EN 50164-1

Three-part, (with intermediate plate) for round and flat conductors

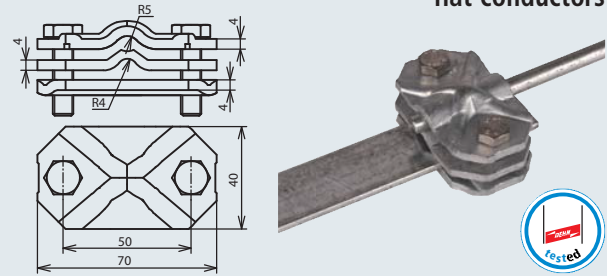

Part No.	454 000
Material	St/tZn
Clamping range Rd / Fl	5-10 / 30-40 mm
Screw	☛ M8x30 mm
Material of screw	StSt
Standard	EN 50164-1

Two-part, for two flat conductors

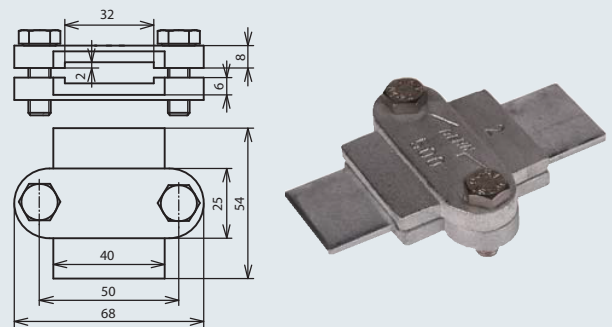

Part No.	455 000
Material	MCl/tZn
Clamping range Fl / Fl	30 / 30 mm
Screw	☛ M8x25 mm
Material of screw	StSt
Standard	EN 50164-1

Bimetallic Disconnecting Clamp with Shield

Bimetallic type to interconnect conductors made of different materials



Part No.	460 147
Material	Cu / St/tZn
Clamping range Rd / Fl	6-10 / 30-40 mm
Screw	☛ M8x16 mm
Material of screw	StSt
Shield	plastic grey
Standard	EN 50164-1

